



6029 - 4 St SE

Lease

HIGHLIGHTS

- Central location just off of 58 Ave. near Blackfoot Trail in the Manchester Business Park
- Close to downtown and other main arterial roads including MacLeod, Glenmore, and Deerfoot Trail
- Ample parking
- New LED lights in office and warehouse
- New carpet and tile in office
- Available Immediately

PROPERTY INFORMATION

Total Rentable Area:	3,187 sq. ft.
Office	1,105 sq. ft.
Warehouse	2,082 sq. ft.
Loading	1– dock 8' x 9'
Power	100 amp @ 120/208
Ceiling	16' high
Lease Rate	\$10.00 psf
Op Costs	\$5.21 psf



Harvey Aronovich
403-560-2059
harvey@target-realty.com



FRONT OFFICE



MEETING ROOM



KITCHEN

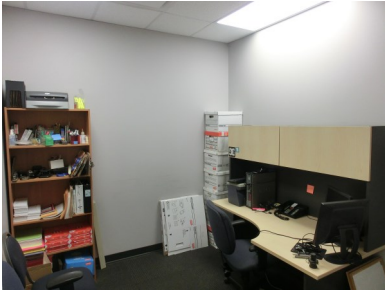

OFFICES



WAREHOUSE



REAR LOADING

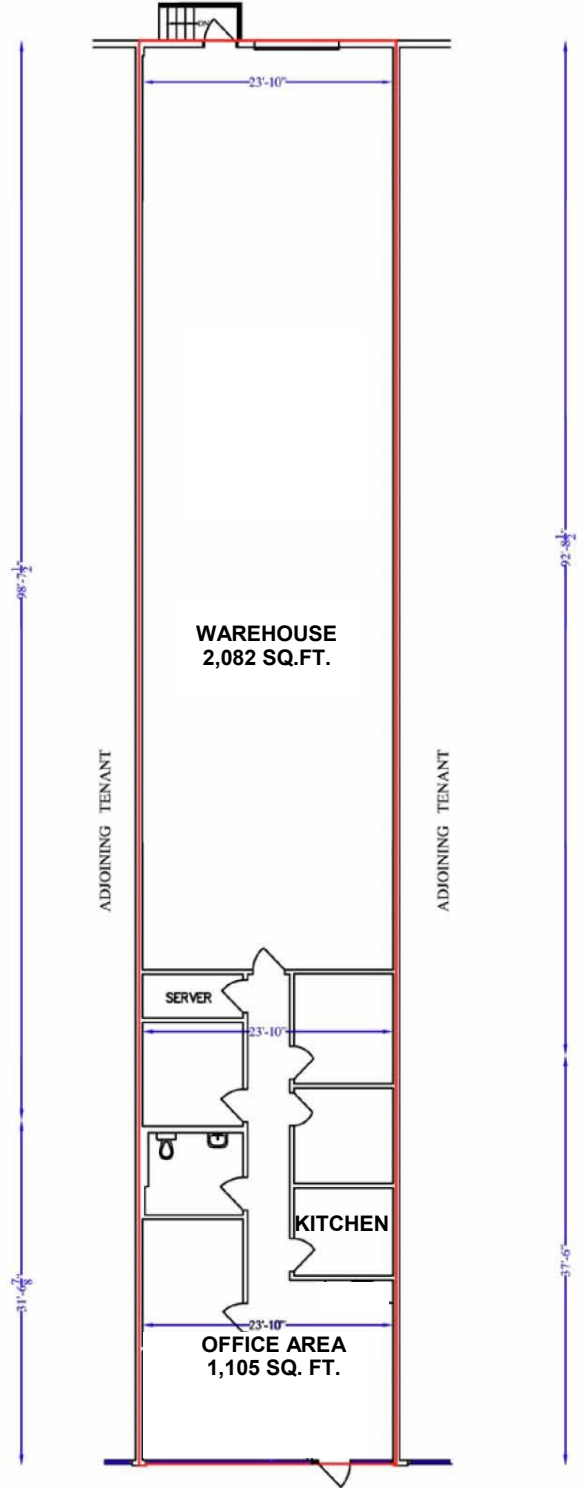

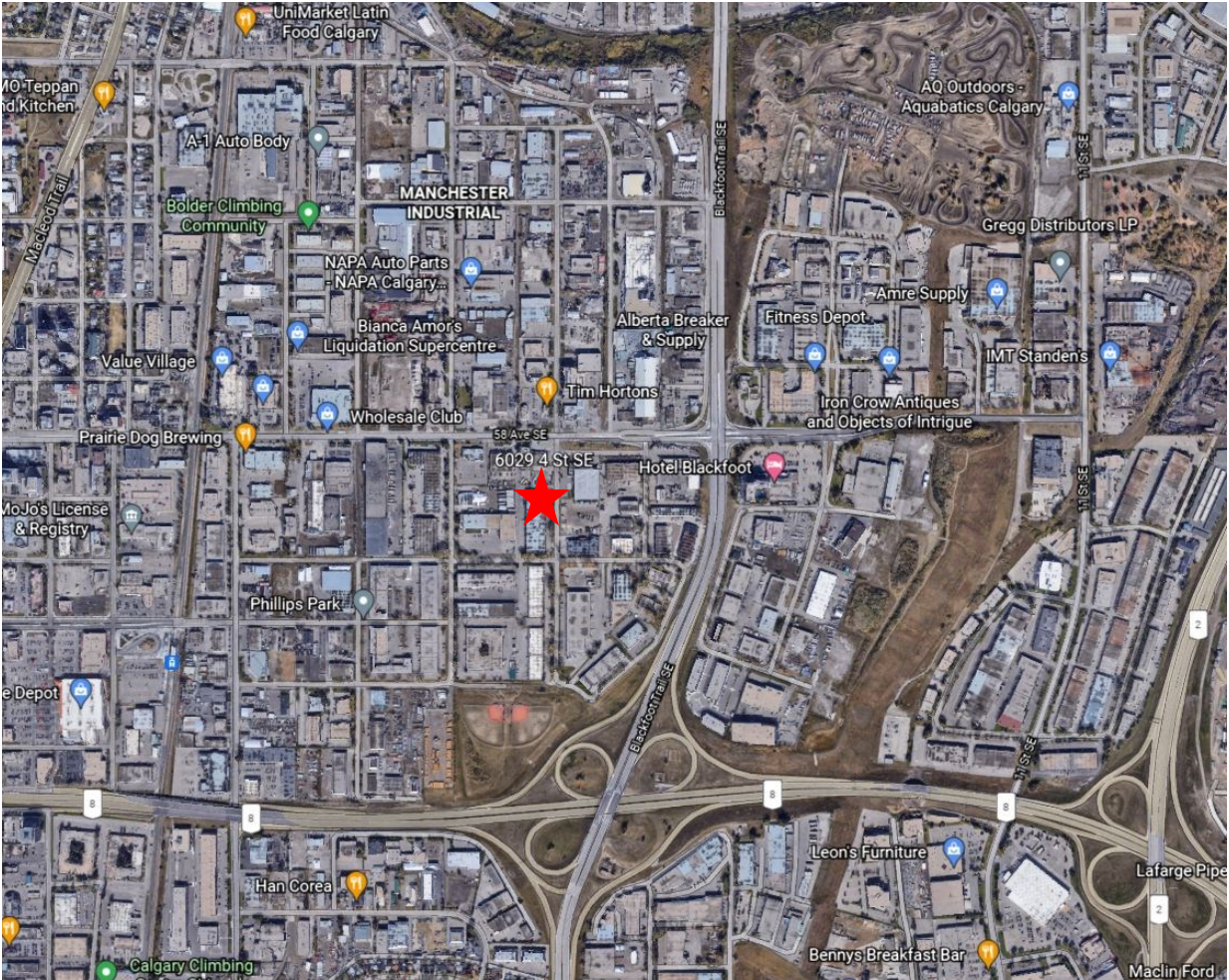
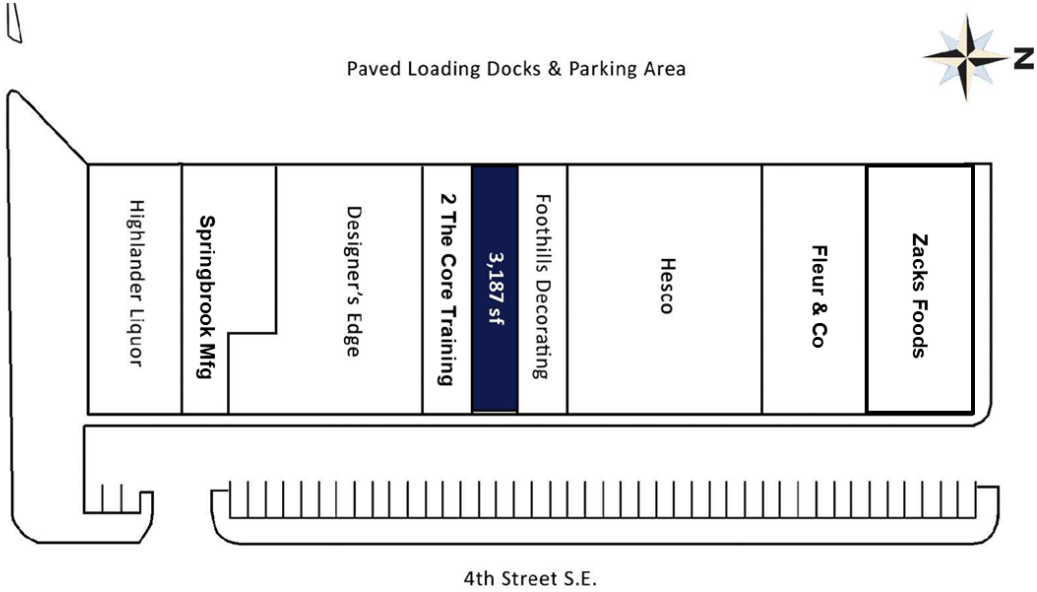

Harvey Aronovich
403-560-2059
harvey@target-realty.com

3, 7725 - 46 Street SE Calgary AB T2C 2Y5 Tel. 403-253-3060 www.target-realty.com

DISCLAIMER: Each page of this information package is intended for the information purposes only and contains information obtained from other sources believed to be correct but which does not form part of any present or future contract. Target Realty Corp. assumes no responsibility for the degree of accuracy of such information contained herein. Prices or rates quoted do not include the Goods and Services Tax. This property is subject to change and/or withdrawal from the market without notice. HA 07/21